

FITTINGS 20K PSI (1380 BAR)

FLEX LANCES

Continued from previous page

9/16-18 THREADED LANCES	SWIVEL SIZE	TOOL END CONNECTION	LENGTH		INSIDE DIA.		OUTER DIA.		CRIMP DIA.		MAWP		WEIGHT		MIN. BEND RAD.	
			ft	m	in	mm	in	mm	in	mm	psi	bar	lb/ft	kg/m	in	mm
ACH0 H84035FTM9NZLM	3/4" Type M	9/16"-18 LH Male BP	35	10.7	0.32	8.1	0.57	14.6	0.79	20.3	21750	1500	0.261	0.390	7.09	108
ACH0 H84035FTM9NZRM	3/4" Type M	9/16"-18 RH Male BP	35	10.7	0.32	8.1	0.57	14.6	0.79	20.3	21750	1500	0.261	0.391	7.09	108
ACH0 H84035FTM9ZLM	3/4" Type M	9/16"-18 LH Male BP	35	10.7	0.32	8.1	0.57	14.6	0.79	20.3	21750	1500	0.261	0.392	7.09	108
ACH0 H84035FTM9ZRF	3/4" Type M	9/16"-18 RH Female	35	10.7	0.32	8.1	0.57	14.6	0.79	20.3	21750	1500	0.261	0.393	7.09	108
ACH0 H84050FTM9NZLM	3/4" Type M	9/16"-18 LH Male BP	50	15.25	0.32	8.1	0.57	14.6	0.79	20.3	21750	1500	0.261	0.394	7.09	108
ACH0 H84050FTM9NZRM	3/4" Type M	9/16"-18 RH Male BP	50	15.25	0.32	8.1	0.57	14.6	0.79	20.3	21750	1500	0.261	0.395	7.09	108
ACH0 H84050FTM9ZRF	3/4" Type M	9/16"-18 RH Female	50	15.25	0.32	8.1	0.57	14.6	0.79	20.3	21750	1500	0.261	0.396	7.09	108

TYPE M MALE CONNECTORS

PART NO.	CONNECTION TYPE		MAX. OPERATING PRESSURE	
	Connection 1	Connection 2	psi	bar
AF 060-060	9/16" Type M Male	9/16" Type M Male	44k	3000
AF 060-061	9/16" Type M Male	3/4" Type M Male	22k	1500
AF 060-063	9/16" Type M Male	1" Type M Male	22k	1500
AF 061-061	3/4" Type M Male	3/4" Type M Male	22k	1500
AF 061-063	3/4" Type M Male	1" Type M Male	22k	1500
AF 061-064	3/4" Type M Male	1-5/16" Type M Male	22k	1500
AF 062-062	7/8" Type M Male	7/8" Type M Male	44k	3000
AF 062-063	7/8" Type M Male	1" Type M Male	22k	1500
AF 063-063	1" Type M Male	1" Type M Male	22k	1500
AF 063-064	1" Type M Male	1-5/16" Type M Male	22k	1500
AF 064-064	1-5/16" Type M Male	1-5/16" Type M Male	22k	1500

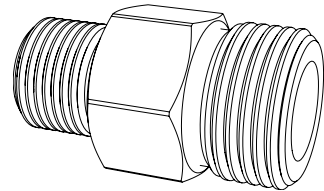

TYPE M MALE TO MEDIUM PRESSURE MALE CONNECTORS

PART NO.	CONNECTION TYPE		MAX. OPERATING PRESSURE	
	Connection 1	Connection 2	psi	bar
AF 060-MP4	9/16" Type M Male	1/4" MP Male	22k	1500
AF 060-MP6	9/16" Type M Male	3/8" MP Male	22k	1500
AF 060-MP9	9/16" Type M Male	9/16" MP Male	22k	1500
AF 060-MP12	9/16" Type M Male	3/4" MP Male	22k	1500
AF 060-MP16	9/16" Type M Male	1" MP Male	22k	1500
AF 061-MP6	3/4" Type M Male	3/8" MP Male	22k	1500
AF 061-MP9	3/4" Type M Male	9/16" MP Male	22k	1500
AF 061-MP12	3/4" Type M Male	3/4" MP Male	22k	1500
AF 061-MP16	3/4" Type M Male	1" MP Male	22k	1500
AF 063-MP9	1" Type M Male	9/16" MP Male	22k	1500
AF 063-MP12	1" Type M Male	3/4" MP Male	22k	3000
AF 063-MP16	1" Type M Male	1" MP Male	22k	1500
AF 064-MP9	1-5/16" Type M Male	9/16" MP Male	22k	1500
AF 064-MP12	1-5/16" Type M Male	3/4" MP Male	22k	1500
AF 064-MP16	1-5/16" Type M Male	1" MP Male	22k	1500

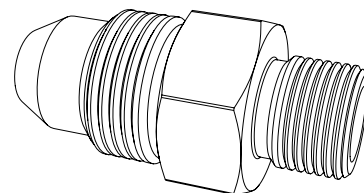

FITTINGS 20K PSI (1380 BAR)

THREAD LUBRICANTS

Protect the threads from galling or seizing up.



PART NO. GP 043
Blue Goop Thread Lubricant 2 oz. Tube

LUBRICANTS

MSDS sheets are available for all lubricants.

LUBRICANT	PART NUMBER	QTY	DESCRIPTION
VISCOUS FLUID	BJ 048-X	6 oz.	Synthetic Silicone Lubricant
AIR MOTOR OIL	GP 041	32 oz.	Almo 525/ISO 46/SAE 10
AUTO TRANS. FLUID	GP 042	32 oz.	Mercon®/Dexron® ATF
ANTI-SEIZE	GP 043	2 oz.	Blue Goop®
MOTOR OIL	GP 044	32 oz.	10W-40
GEARBOX LUBE	GP 046	32 oz.	80W-85W-90
THREAD SEALANT	GP 047	4 oz.	ThreadMate®
GREASE	GP 048	14 oz.	Synthetic Grease SHC 100

* Please specify "fast" or "slow" for the type of viscous fluid needed.



RUPTURE DISC

A Rupture Disc is an essential component in any system which contains a positive displacement pump. It provides protection against excessive pressure building up in the water blasting equipment connected to a pump.

PART NO.	DESCRIPTION
ACRD 35005125	Rupture Disc, 12.5k, 1/2 STD
ACRD 35005148	Rupture Disc, 14.8k, 1/2 STD
ACRD 35005175	Rupture Disc, 17.5k, 1/2 STD
ACRD 35006125	Rupture Disc, 12.5k Burst 1/4 A/S
ACRD 35006240	Rupture Disc, 24k, 1/4
ACRD 35006435	Rupture Disc, 43.5K Burst 1/4 A/S
ACRD 35006509	Rupture Disc, 50k, 1/4 W/TAG
ACRD 35008001	Ring 1/2 15K Rupture Disc Hold Down
ACRD 35008011	Ring 20/40K Rupture Disc Hold Down
ACRD 35009115	Rupture Disc, 11.5k, 3/4, NLB
ACRD 35009222	Rupture Disc, 22.25k, 3/4, NLB
ACRD 35015120	Rupture Disc, 12K J/S
ACRD 35017240	Rupture Disc, 24k, J/S

