

# 44K (3000 bar) BARRACUDA®, GOPHER, AND SL: NEW CARTRIDGE HIGH PRESSURE SEAL ASSEMBLY

The BC 705 Cartridge was designed to improve the seal life for the BC-H9-C Barracuda®. The new cartridge assembly is a drop in replacement for the BC 505-S and is interchangeable with all existing 44k (3000 bar) Barracuda®, Gopher, and SL swivels.

BC 705 test results indicate a slight increase in High Pressure Seal torque. Due to the increase in High Pressure Seal torque, the BC-H9LF-C requires a minimum of .015" nozzles throughout the pressure range for proper function and rotation. If using .014" nozzles is critical to your operation, it is possible to convert your BC-H9-C to a BC-H9LF-C or a BC-H9-XXLF-C-Ti model by exchanging the head, stub shaft, and shield. An updated jetting chart is available at; [www.stoneagetools.com/tool-manuals/](http://www.stoneagetools.com/tool-manuals/)

Operational questions, troubleshooting guidance, and concerns, regarding the BC 705 cartridge can be directed to StoneAge Sales at [sales@stoneagetools.com](mailto:sales@stoneagetools.com).



BC 721  
SNAP FIT HOUSING

## BC 705 CARTRIDGE

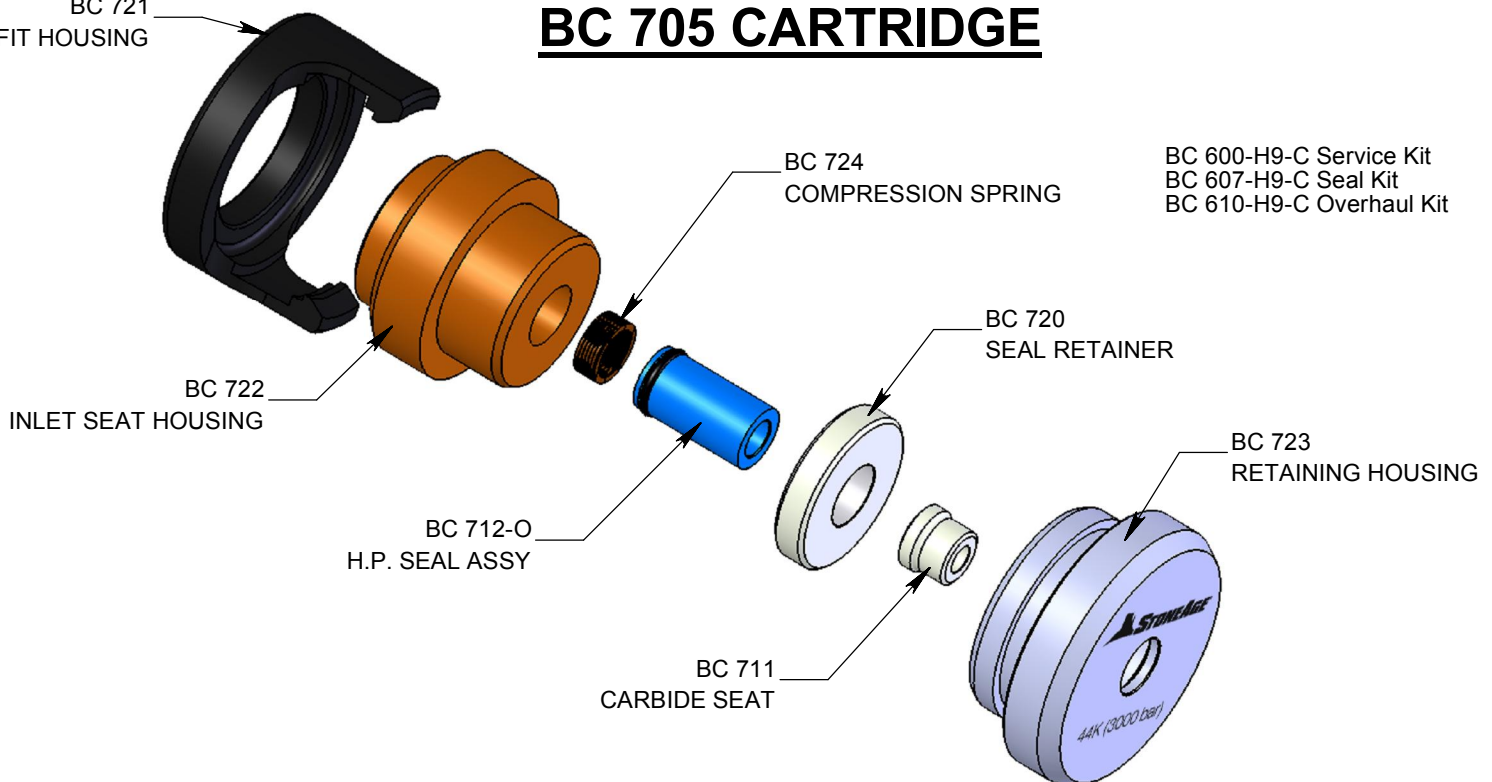

NOTE: When replacing the cartridge, inspect the end of the shaft in the swivel for damage such as galling or erosion, StoneAge recommends replacing damaged shafts. All kits include either the complete new cartridge or all the parts needed to rebuild the cartridge.

